

HAND PALLET TRUCKS

2.5 tonnes

THE ECONOMICAL CHOICE FOR SHORT-DISTANCE TRANSPORTATION

Our Economy hand pallet truck comes equipped with all that is needed to provide good long-term performance at an inexpensive price. With a load capacity of 2.5 tonnes, this durable hand pallet truck increases productivity and efficiency in warehouse and retail applications, providing you with the most economical choice for short-distance transportation.

SPECIFICATIONS

MV25MNTN	MV25IPTP
MV25MNSN	MV25IRTP
MV25MPSP	MV25HRTP
MV25MRTP	MV25OPSP
MV25MPTP	MV25ORTP



**WHEN
RELIABILITY IS
EVERYTHING...**

MV25 Series HAND PALLET TRUCKS

2.5 tonnes

POPULAR FEATURES

- # 1 Ergonomic handle
- # 2 Foot pedal release valve
- # 3 Integrated ACBF* pump
- # 4 Durable chassis
- # 5 Rounded fork tips
- # 6 Rising forks



#1 Ergonomic handle is designed for comfortable use for hands of all sizes and has a tough coating for long-lasting performance. Control lever has three operating positions; raise, lower and neutral.

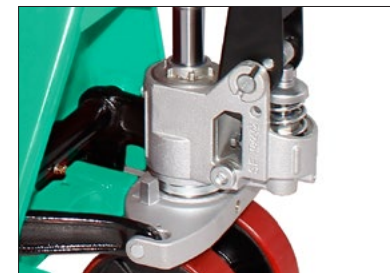

#2 Foot pedal release valve.



#3 Integrated ACBF* pump has heavy-duty construction for durability and features overload protection. * Only on 540 x 1150.



#4 Durable chassis is constructed from powder-coated heavy-gauge steel.



#5 Rounded fork tips fork tip rollers for easy pallet entry / exit.

#6 Rising forks; minimum height: 85mm maximum height: 200mm

VDI - PERFORMANCE & DIMENSIONS

CHARACTERISTICS			Mitsubishi Forklift Trucks				
			MV25MNTN	MV25MNSN	MV25MPSP	MV25MRTP	MV25MPTP
1.1	Manufacturer		Pedestrian				
1.2	Manufacturer's model designation						
1.4	Operator type		Pedestrian				
1.5	Load capacity	Q (kg)	2500	2500	2500	2500	2500
1.6	Load centre distance	c (mm)	600	600	600	600	600
1.8	Load wheel axle to fork face (forks lowered)	x (mm)	43	43	43	43	43
1.9	Wheelbase	y (mm)	1180	1180	1180	1180	1180
WEIGHT							
2.1	Truck weight without load, with maximum battery weight	kg	69	68	71	71	72
WHEELS, DRIVE TRAIN							
3.1	Tyres: PT = Power Thane, Vul = Vulkollan, P = Polyurethane, N = Nylon, R = Rubber drive / load side		NTN	NSN	PSP	RTP	PTP
3.2	Tyre dimensions, drive side	(mm)	200	200	200	200	200
3.3	Tyre dimensions, load side	(mm)	80	80	80	80	80
3.4	Castor wheel dimensions (diameter x width)	(mm)	2/4	2/2	2/2	2/4	2/4
3.6	Track width (centre of tyres), drive side	b10 (mm)	120	120	120	120	120
3.7	Track width (centre of tyres), load side	b11 (mm)	380	380	380	380	380
DIMENSIONS							
4.4	Lift height	h3 (mm)	115	115	115	115	115
4.9	Height of tiller arm / steering console (min/max)	h14 (mm)	680/1240	680/1240	680/1240	680/1240	680/1240
4.15	Fork height, fully lowered	h13 (mm)	85	85	85	85	85
4.19	Overall length	l1 (mm)	1545	1545	1545	1545	1545
4.20	Length to fork face	l2 (mm)	1150	1150	1150	1150	1150
4.21	Overall width	b1/b2 (mm)	540	540	540	540	540
4.22	Fork dimensions (thickness, width, length)	s / e / l (mm)	50, 160 & 1150	50, 160 & 1150	50, 160 & 1150	50, 160 & 1150	50, 160 & 1150
4.25	Outside width over forks (minimum / maximum)	b5 (mm)	540	540	540	540	540
4.32	Ground clearance at centre of wheelbase, (forks lowered)	m2 (mm)	85	85	85	85	85
4.33b	Working aisle width (Ast3) with 1000 x 1200 mm pallets, load crosswise	Ast3 (mm)	2350	2350	2350	2350	2350
4.34b	Working aisle width (Ast3) with 800 x 1200 mm pallets, load lengthwise	Ast3 (mm)	N/A	N/A	N/A	N/A	N/A
4.35	Turning radius	Wa (mm)	1380	1380	1380	1380	1380

MODEL	FORK DIMENSIONS WxL (mm)	LOAD WHEELS (80mm)	DRIVE WHEEL (200mm*)
MV25MNTN	540 x 1150	4 x (Tandem) Nylon	2 x Nylon*
MV25MNSN		2 x (Single) Nylon	2 x Nylon*
MV25MPSP		2 x (Single) Polyurethane	2 x Polyurethane*
MV25MRTP		4 x (Tandem) Polyurethane	2 x Rubber*
MV25MPTP		4 x (Tandem) Polyurethane	2 x Polyurethane*
MV25IPTP (BF pump)	685 x 1000	4 x (Tandem) Polyurethane	2 x Polyurethane (180mm)
MV25IRTP (BF pump)	685 x 1000	4 x (Tandem) Polyurethane	2 x Rubber (180mm)

Other configurations available on request.



Continuing improvement may lead to changes in these specifications

HAND PALLET TRUCKS

MV25 Series

2.5 tonnes

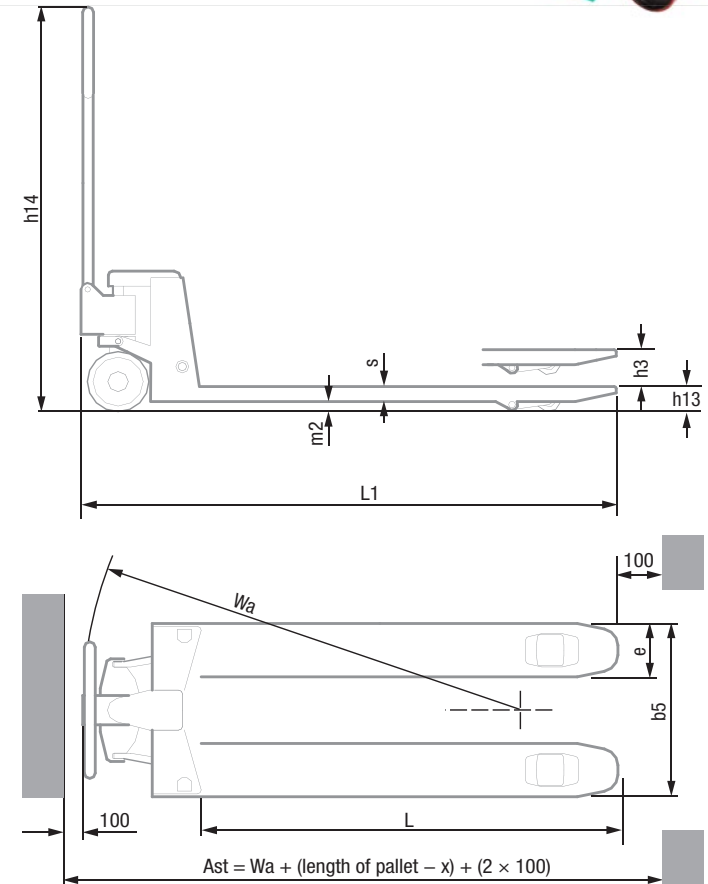

VDI - PERFORMANCE & DIMENSIONS

CHARACTERISTICS			Mitsubishi Forklift Trucks				
1.1	Manufacturer		MV25IPTP	MV25IRTP	MV25H RTP	MV250PSP	MV250RTP
1.2	Manufacturer's model designation						
1.4	Operator type		Pedestrian				
1.5	Load capacity	Q (kg)	2500	2500	2500	2500	2500
1.6	Load centre distance	c (mm)	550	550	600	400	400
1.8	Load wheel axle to fork face (forks lowered)	x (mm)	43	43	43	43	43
1.9	Wheelbase	y (mm)	1036	1036	1186	830	830
WEIGHT							
2.1	Truck weight without load, with maximum battery weight	kg	75	74	70	61	62
WHEELS, DRIVE TRAIN							
3.1	Tyres: PT = Power Thane, Vul = Vulkollan, P = Polyurethane, N = Nylon, R = Rubber drive / load side		PTP	RTP	RTP	PSP	RTP
3.2	Tyre dimensions, drive side	(mm)	180	180	180	200	200
3.3	Tyre dimensions, load side	(mm)	80	80	80	80	80
3.4	Castor wheel dimensions (diameter x width)	(mm)	2/4	2/4	2/4	2/2	2/4
3.6	Track width (centre of tyres), drive side	b10 (mm)	120	120	120	120	120
3.7	Track width (centre of tyres), load side	b11 (mm)	525	525	525	380	380
DIMENSIONS							
4.4	Lift height	h3 (mm)	115	115	115	115	115
4.9	Height of tiller arm / steering console (min/max)	h14 (mm)	550/1220	550/1220	550/1220	680/1220	680/1220
4.15	Fork height, fully lowered	h13 (mm)	85	85	85	85	85
4.19	Overall length	l1 (mm)	1405	1405	1545	1195	1195
4.20	Length to fork face	l2 (mm)	1000	1000	1150	800	800
4.21	Overall width	b1/b2 (mm)	685	685	685	540	540
4.22	Fork dimensions (thickness, width, length)	s / e / l (mm)	50, 160 & 1000	50, 160 & 1000	50, 160 & 1150	50, 160 & 800	50, 160 & 800
4.25	Outside width over forks (minimum / maximum)	b5 (mm)	685	685	685	540	540
4.32	Ground clearance at centre of wheelbase, (forks lowered)	m2 (mm)	85	85	85	85	85
4.33b	Working aisle width (Ast3) with 1000 x 1200 mm pallets, load crosswise	Ast3 (mm)	2200	2200	2350	1820	1820
4.34b	Working aisle width (Ast3) with 800 x 1200 mm pallets, load lengthwise	Ast3 (mm)	N/A	N/A	N/A	N/A	N/A
4.35	Turning radius	Wa (mm)	1225	1225	1375	1030	1030

MODEL	FORK DIMENSIONS WxL (mm)	LOAD WHEELS (80mm)	DRIVE WHEEL (200mm*)
MV25MNTN	540 x 1150	4 x (Tandem) Nylon	2 x Nylon*
MV25MNSN		2 x (Single) Nylon	2 x Nylon*
MV25MPSP		2 x (Single) Polyurethane	2 x Polyurethane*
MV25MRTP		4 x (Tandem) Polyurethane	2 x Rubber*
MV25MPTP		4 x (Tandem) Polyurethane	2 x Polyurethane*
MV25IPTP (BF pump)	685 x 1000	4 x (Tandem) Polyurethane	2 x Polyurethane (180mm)
MV25IRTP (BF pump)	685 x 1000	4 x (Tandem) Polyurethane	2 x Rubber (180mm)

Other configurations available on request.



Continuing improvement may lead to changes in these specifications

HAND PALLET TRUCKS

MV25 Series

2.5 tonnes

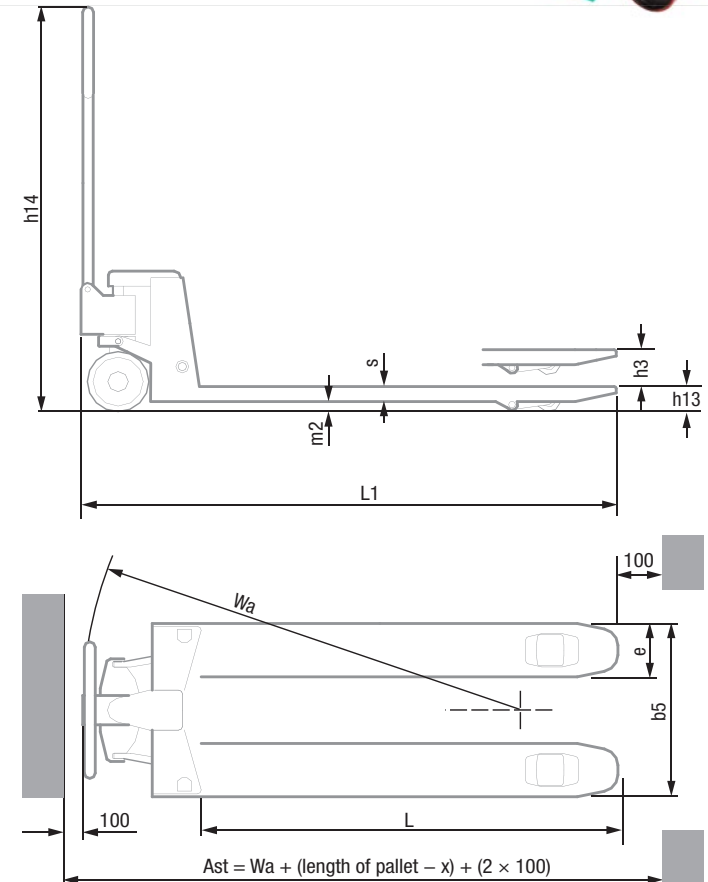

WHEN RELIABILITY IS EVERYTHING...



Like any products bearing "MITSUBISHI" on its product name our materials handling equipment benefits from the tremendous heritage, huge resources and cutting-edge technology of one of the world's largest corporations – Mitsubishi Heavy Industries Group.

Engineering spacecraft, jet planes, power plants and more, MHI specialises in those technologies where performance, dependability and superiority decide your success or failure...

So when we promise you quality, reliability and value for money, you know it's a guarantee we have the power to deliver.

That's why every model in our award-winning and comprehensive range of lift trucks and warehouse equipment is built to a high specification – to ensure it keeps working for you. Day after day. Year after year. Whatever the job. Whatever the conditions.

YOU'LL NEVER WORK ALONE

As your local authorised dealer, we are here to keep your trucks working – through our extensive experience, our technical excellence and our commitment to customer care.

We are your local experts, backed by efficient channels to the entire organisation of Mitsubishi Forklift Trucks.

No matter where you are, we are close by – with the capability to meet your needs.

Discover how Mitsubishi Forklift Trucks give you more from your local authorised dealer or when you visit our website www.mitforklift.com

Performance specifications may vary depending on standard manufacturing tolerances, vehicle condition, types of tyres, floor or surface conditions, applications or operating environment. Trucks may be shown with non-standard options. Specific performance requirements and locally available configurations should be discussed with your distributor of Mitsubishi forklift trucks. We follow a policy of continual product improvement. For this reason, some materials, options and specifications could change without notice.

info@mitforklift.com

(05/22) © 2022 MLE B.V. (registration no. 33274459). All rights reserved.



Mitsubishi Logisnext Europe B.V.
Hefbrugweg 77, 1332 AM Almere
The Netherlands
Tel: +31 (0)36 5494 411



mft2.eu/fb



mft2.eu/apps



mft2.eu/youtube



mft2.eu/facebook

